

Before connection

Disconnect the flat cable on the cassette deck. ④

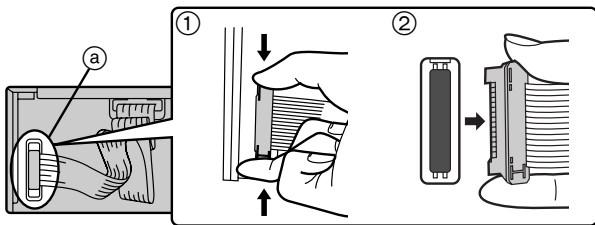

1 Connect the flat cables.

Connect the flat cables to the terminals on each unit.

Note

Do not connect or disconnect the flat cables while the unit is on.

After connection:

Keep cables as flat against the back of the unit as possible.

2 Connect the FM indoor antenna.

Tape the antenna to a wall or column where radio signals are received with the least amount of interference.

Note

When you cannot get good reception with this FM indoor antenna, we recommend you install an FM outdoor antenna (not included).

3 Connect the AM loop antenna.

You can also install the AM loop antenna on the rear of the cassette deck, wall or pillars.

In this case, be sure to use the antenna holder with the hole.

•To install on the cassette deck rear (⑤)

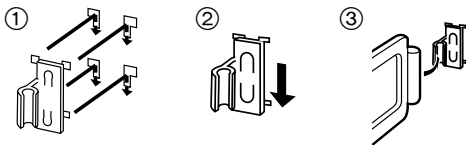

•To install on walls or pillars

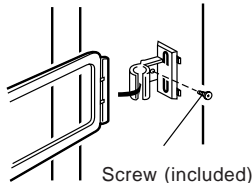

Note

Minimize noise by bundling the cord with tape to keep it away from the flat cables.

4 Connect the right (R) and left (L) speaker cables.

Connect the speaker cables to the terminal levers of the same color.

Use only the supplied speakers.

The combination of the main unit and front speakers provide the best sound. Using other speakers can damage the unit and sound quality will be negatively effected.

Note

- To prevent damage to circuitry, never short-circuit positive (+) and negative (-) speaker wires.
- Be sure to connect only positive (red or gray) wires to positive (+) terminals and negative (black or blue) wires to negative (-) terminals.

(United Kingdom only)

BE SURE TO READ THE CAUTION FOR AC MAINS LEAD BEFORE PROCEEDING TO STEP 5.

5 Connect the AC mains lead.

Insertion of Connector

Even when the connector is perfectly inserted, depending on the type of inlet used, the front part of the connector may jut out as shown in the drawing.

However there is no problem using the unit.

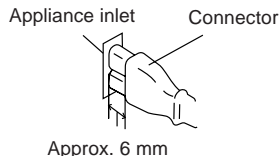

For your reference:

Information you enter into the unit's memory, except for the time, remains intact for up to two weeks after the mains lead is disconnected.